

PRODUCTS CATALOGUE

Sulson International was established in 2008 and took over its business from its sister concern E Hebtullah & Co which was in iron steel business from three decades. And has since evolved to become Pakistan's leading distributor of iron & steel products. We import our products from some of world's finest makers of iron & steel mainly from China.

-
- Sheets
 - Structure Steel
 - Round Steel
 - Pipes

About Us

Sulson International was established in 2008 and took over its business from its sister concern E Hebtullah & Co which was in iron steel business from three decades. And has since evolved to become Pakistan's leading distributor of iron & steel products. We import our products from some of world's finest makers of iron & steel mainly from China. Locally our list of valued suppliers also have Pakistan Steel Mills Corporation, Jabbar Steel Mill, International Steel Limited and Ayesha Steel Mill. We have the range of products, ready stock and competitive price so that need of our customers will be met at all times. Our product range include all Mild Steel Products like Ms Sheets, Structural Steel and Galvanized Steel. We have warehousing facility located at Nishter Road with overhead cranes lifting maximum capacity of 30,000 kg, computerized weighing scales and coil stacking / De-coiling system.

**Clients trust us
with their big
orders as they
know that Sulson
delivers on its
commitments.**



**We offer best industrial
services. 14+ years of
experience with global
industries.**

**“Clients trust us with
their big orders as they
know that Sulson
delivers on its
commitments.”.**

Our Products | SHEETS



H.R. Sheets (M S Sheet)

H.R basically stands for HOT ROLLED. These are prepared from hot rolled coils by using appropriate technology. We procure our range from reliable vendors who use quality material with a suitable width and thickness in different grades to the fabricate product.



H.R. Plates (M S Plates)

H.R stands for HOT ROLLED. We are offering HR / Mild Steel Sheets. These are used for light/heavy structural, mechanical and general engineering purpose. These mild steel (M.S Steel) confirm to grade ASTM A 36. Thickness of MS Plates are from 12 mm till 100mm.

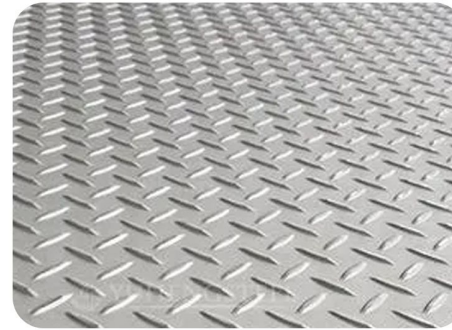

MS Chequered Plate

Our clients can avail from us a wide range of M.S. chequered plates, which is known for good tensile strength and high degree of abrasion resistance. Therefore, our Chequered plates are widely appreciated for applications like industrial flooring,



Galvanized (GI) Sheets & Coils

The protective layer of a galvanized steel sheet will corrode eventually, leaving the steel unprotected and prom to oxidization. While it is widely used, cold-rolled Steel is subject to rust and Corrosion over time due to exposure to moisture or chemicals. Galvanized steel sheet.

Our Products | STRUCTURE STEEL



M.S. I-Beam

I Beam is an I shaped cross section. The horizontal elements of the "I" are known as flanges, while the vertical element is termed the "web". I-beams are usually made of structural steel and are used in construction and civil engineering. I Beam provides economical floor and roof systems where applications requiring long clear spans and lighter weight systems.



M.S. H-Beam

These are the H Cross section used in the joints and are used in support for various types of structural / mechanical works. The width of the flange would be equal to the height of the cross section wherea as in the case of I section, the height of the cross section would be higher than the width of the flange. The shear strength is better in the case of I beam. These Products Basic sizes available.

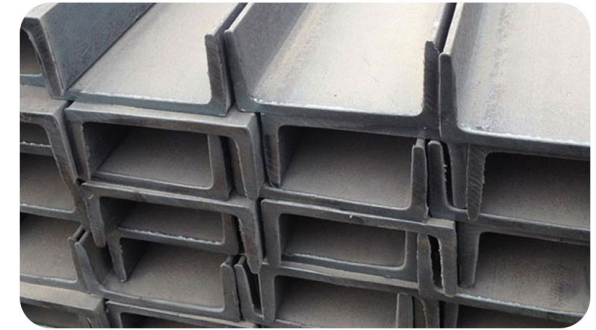

M.S. Channel

Ms Channel Are U Shaped Structural Steel Used As Structural Support In Construction Work. Available In Various Sizes And Lengths. We Have Both Local And Imported Channels To Offer To Our Clients

Our Products | STRUCTURE STEEL

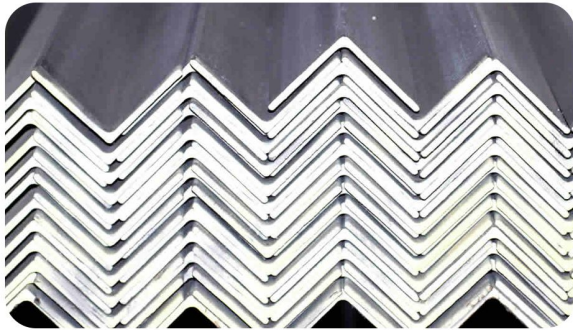

M.S. Angle

Ms Angle is made of Structural Steel and is in shape of V. Equal Angles are in ready stock and used in various architectural needs in construction buildings, homes, offices and factories. MS Angle is available in various sizes and length as per requirement. Unequal Angles are not in ready stock but can be imported on customers requirement.



M.S. Flats

MS Flat Bar is available in various thickness and lengths. We can also provide flat bars by gas cutting in various sizes. Our range of flat bar finds application in several industries for fabrication purpose such as shutters, window panes, grills, bus bodies etc... We have size from 25 x 3 mm till 100 x 12 mm. Wear and tear resistant.

- | | |
|--------------------------|--------------------------|
| 1) Construction Frames | 7) Smooth Finish |
| 2) Agriculture Machinery | 8) Dimensionally Correct |
| 3) Trimming | 9) Edge Finish |
| 4) Brackets | |
| 5) Framing | |
| 6) Durable | |

Our Products | ROUND STEEL



Deformed Bar

Our firm has vendor association with Amreli Steel and Agha Steel. We offer is huge inquiry Tor / Deformed steel bars. The most commonly used steel bar for concrete reinforcement is TOR steel. The other names of TOR steel are CTD bar, Deformed bar, Twisted bar etc.

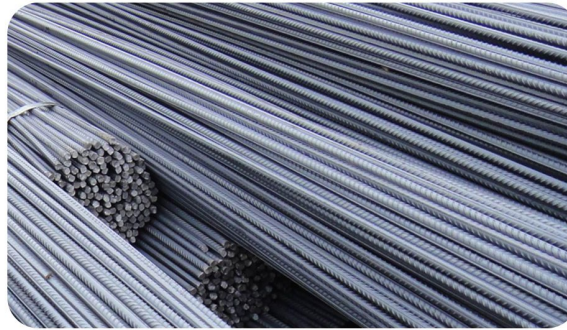

TOR Bar

Our firm has vendor association with Amreli Steel and Agha Steel. We offer is huge inquiry Tor / Deformed steel bars. The most commonly used steel bar for concrete reinforcement is TOR steel. The other names of TOR steel are CTD bar, Deformed bar, Twisted bar etc.

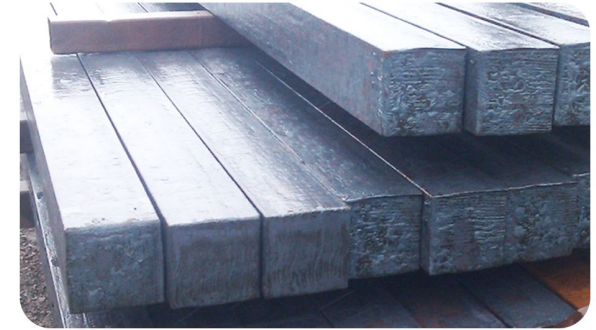

Square Bar

MS Round, Square and Hexagonal Bars are used for making essential parts in industrial sectors. We can provide our clients these bars of required grade. These Products are available in Polish / Non Polish Materials.

Our Products | STRUCTURE STEEL



Plain Bar

MS Round, Square and Hexagonal Bars are used for making essential parts in industrial sectors. We can provide our clients these bars of required grade. These Products are available in Polish / Non Polish Materials.

- 1) Diameter: 6 mm To 50 mm is polished
- 2) Length: 3 meter to 8 meter approx
- 3) Diameter: 6 mm To 250 mm is non polished
- 4) Length: 3 meter to 10 meter approx

And more sizes are Available on costumers demand.



Hexagonal Bar

MS Round, Square and Hexagonal Bars are used for making essential parts in industrial sectors. We can provide our clients these bars of required grade. These Products are available in Polish / Non Polish Materials.

- 1) Diameter: 6 mm To 50 mm is polished
- 2) Length: 3 meter to 8 meter approx
- 3) Diameter: 6 mm To 250 mm is non polished
- 4) Length: 3 meter to 10 meter approx

And more sizes are Available on costumers demand.

Our Products | PIPES



Welded Pipes

Welded pipes are made in accordance to BS EN 10219 and reduces total project costs for labour, installation, shipping, administration and manufacturing. These pipes can be used for structural applications as well as fluid transmission. These high quality MS pipes are made in IIL's state-of-the-art facility and are backed by the company's promise of quality, trust & reliability that has been its hallmark.



ERW Pipes

SULSON API line pipes are marked and embossed (inside or outside) according to customer requirements. The nominal diameter of IIL line pipes ranges from $\frac{3}{4}$ " to $12 \frac{3}{4}$ " with the length ranging from 6 meters to 12.20 meters.

Used in natural gas and petroleum distribution systems, IIL's API Line Pipe are longitudinal electric welded steel pipe available in PSL1 and PSL2 specification.



Seamless Pipes

SULSON Firefighting pipes are certified as European Conformity Standards (CE) and Underwriters Laboratories (UL), and are manufactured in accordance with the highest international standards (ASTM A53 Sch. 40, Grade A & B and ASTM A795).

SULSON Fire Fighting pipes are available in nominal diameters of $\frac{1}{2}$ " to 12" with thickness range from 2.77mm to 10.31mm.

Our Products | PIPES



Galvaized Pipes

SULSON galvanized (GI) pipes are made from prime quality steel coil and galvanized using the highest quality zinc.

SULSON Galvanized Iron (GI) pipes are corrosion and rust resistant pipes that are ideal for the transmission of potable water, natural gas, oil and other fluids. They are also used in fencing, low cost shelters and general fabrication.



Scaffolding Pipes

SULSON Safescaf tubes are easy to assemble and suitable for all types of scaffolding projects. A premium quality steel tube that is durable, light weight and high strength, IIL Safescaf is manufactured in accordance with the highest international standards (BS EN 39:2001)

These scaffolding tubes have high tensile strength and are widely demanded for various scaffolding applications.



Hollow Structural Sections (HSS)

SULSON hollow structural sections can be manufactured according to BS EN 10219, ASTM A500, ASTM A53 and ASTM A252 international quality standards, which reflects IIL's adherence to high quality manufacturing.

SULSON Hollow Structural Sections are steel sections that are used in a variety of structural applications.

Our Contact Detail:

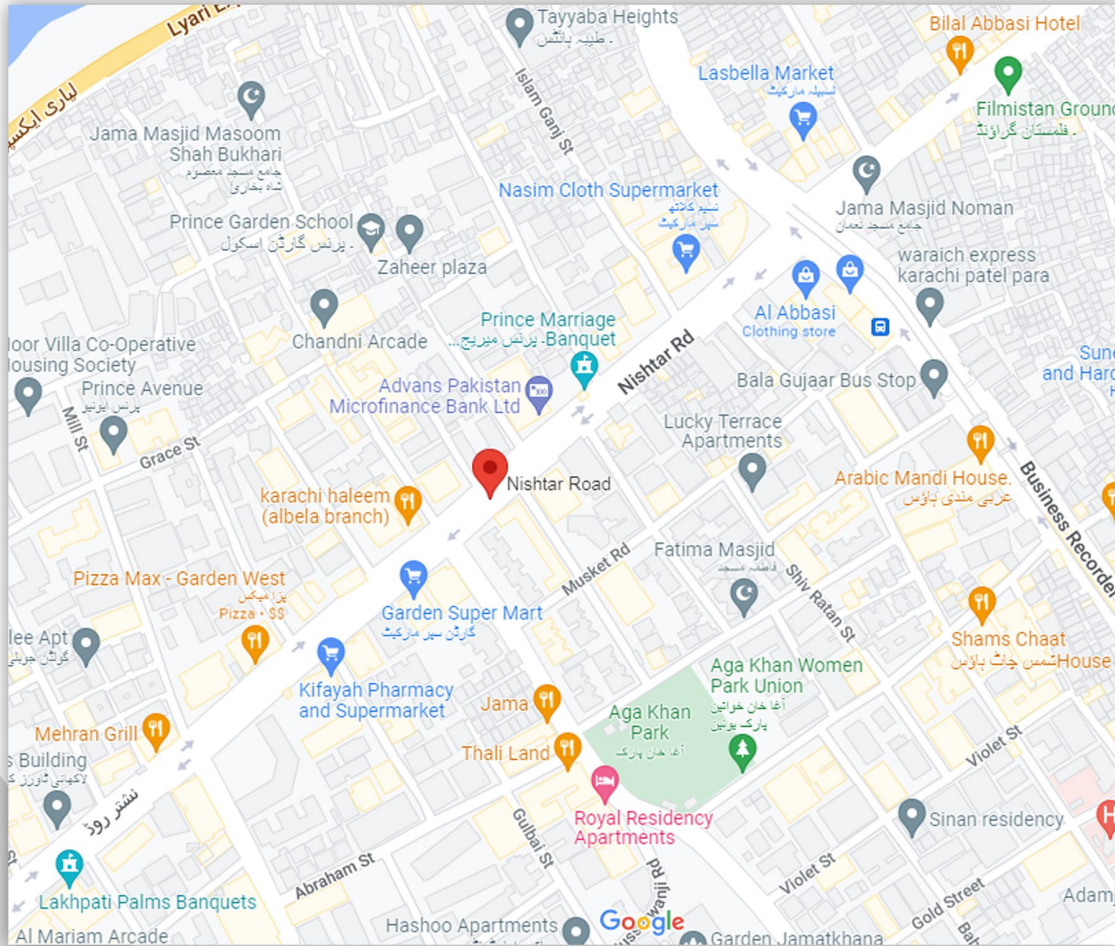

Warehouse & Head Office:

Plot# LR-6/, Kaka Street, Opp. KMC Workshop, Off Nishtar Road, Karachi, Pakistan.

Management:

Siraj Sulemanjee
Chief Executive
Cell: 0333-2152521

Sajjad Siraj Sulemanjee
Managing Director
Cell: 0321-2152521
Email: ali@sulsonintl.com

Contact:

+92 021-32741114
+92 021-327229

info@sulsonintl.com
sulsonintl@gmail.com

www.sulsonintl.com